

Black

MILLWORK CO., INC.

Introduction of the NEW Wood Flush Casement Window Range. Quality as Standard, Not an Option.



Manufactured from Quality knot free Laminated / Engineered Baltic Pine.

Windows are supplied fully finished in White as standard RAL 9010, with options for any RAL colour.

Also units can be stained / lacquer finished.

Available in solid Oak & Ash.

Units are Glazed as standard with Pilkington Low E 24mm Double Glazing with 90% Argon Gas Fill , with Upgraded Thermix Spacer Bar, U Value 1.4.

Roto multipoint locking mechanism and hinges. Winlock furniture fitted as standard, Polished Chrome key locking handles. Also available in White, Brushed Chrome, Brass and Black. Custom furniture RAL colours upon request.

Flush frames 71mm with 35mm stub sill. Optional sills 84mm and 134mm.

Titon Trimvents Xtra R16 fitted as standard through head jamb.

Units come with extensive Warranties, 10 years sealed units and hardware, 5 years paint finish, 10 years on timbers.

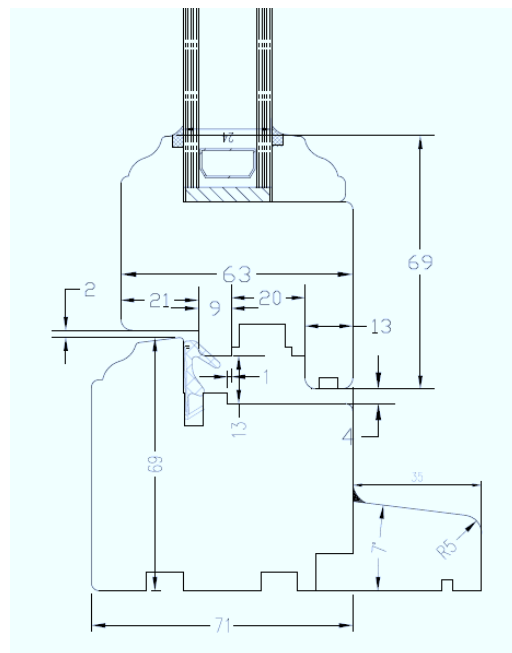
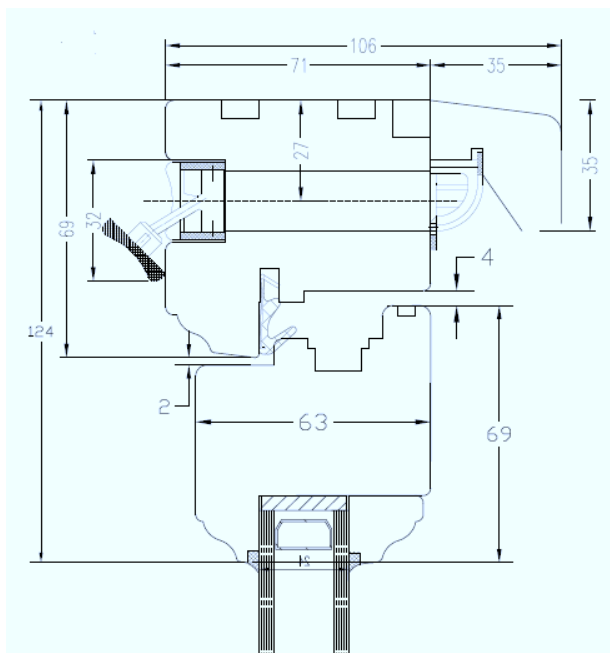

Description

Flush side hung Casement units. Fully Finished in White with Remmers primer ZW-400 and finish top coat DW-690.

Frame & Sash Materials

Engineered Baltic Pine (knot free).

Preservation

All timber components are pressure impregnated with Remmers Induline GL-350 to prevent against insect and fungal attack.

Factory Finish

Windows are supplied fully finished in White RAL 9010 as standard, with options for any RAL colour. Also options for dual colour frames, or painted exterior lacquer interior, or stain / lacquer finish interior and exterior.

Furniture

Supplied Polished Chrome as standard, options of White Silver, Brass and Black. Custom RAL colours upon request.

Grilles

FDL, 19mm profile.



Weatherseal

Schlegel weather strips.

Glazing

Windows are factory glazed with Pilkington Low E glazing with upgraded Thermix Spacer and 90% Argon Gas fill, 24mm (4-16-4) tested to EN1279 U Value 1.4.

Sills

Sills may be supplied 35mm standard projection or with options of 84mm and 134mm projections.

Ventilation

Titon Trimvents Xtra R16 fitted as standard.

Mechanisms

Roto multipoint locking mechanism and hinges. Winlock furniture.

Sizing with Roto Hardware

Min width 483mm, Max width 828mm
Min height 400mm, Max height 1748mm

Sizing with Stalion 2 Hardware

Min width 400mm, Max width 600mm
Min height 400mm, Max height 1878mm

Sizing with Gladiator Hardware

Min width 400mm, Max width 1078mm
Min height 400mm, Max height 1500mm

Guarantees

10 years on sealed units and hardware, 5 years on paint finish against fading, 10 years on timber portions.

Black Millwork Co Inc

Andersen House
Dallow Street
Burton on Trent
Staffordshire
DE14 2PQ

Phone: 01283 511122

Fax: 01283 510863

E-mail: info@blackmillwork.co.uk

Web: www.blackmillwork.co.uk

Black
MILLWORK CO., INC.